

COMPONENTS OF CONTRACT PLANS SET

- ROADWAY PLANS
- SIGNING AND PAVEMENT MARKING PLANS
- SIGNALIZATION PLANS
- LIGHTING PLANS

A DETAILED INDEX APPEARS ON THE KEY SHEET OF EACH COMPONENT

STATE OF FLORIDA  
DEPARTMENT OF TRANSPORTATION

CONTRACT PLANS

FINANCIAL PROJECT ID 430605-1-52-01  
BROWARD COUNTY (86065000)  
STATE ROAD NO. 845 / POWERLINE ROAD

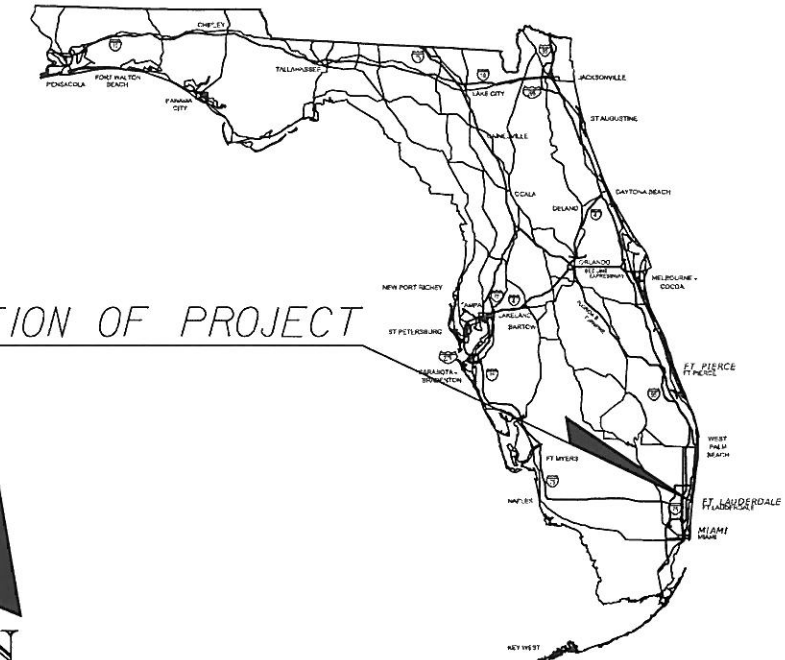

LOCATION OF PROJECT

INDEX OF ROADWAY PLANS

SHEET NO.	SHEET DESCRIPTION
1	KEY SHEET
2 - 3	SUMMARY OF PAY ITEMS
4	TYPICAL SECTION
5 - 23	SUMMARY OF QUANTITIES
24	SUMMARY OF DRAINAGE STRUCTURES
25	OPTIONAL MATERIALS TABULATION
26	GENERAL NOTES & PAY ITEM NOTES
27 - 39	ROADWAY PLAN
40 - 45	DRAINAGE STRUCTURES
46 - 93	CROSS SECTIONS
94 - 96	STORMWATER POLLUTION PREVENTION PLAN
97	TRAFFIC CONTROL PLAN GENERAL NOTES
98 - 99	TRAFFIC CONTROL PLANS
100 - 112	UTILITY ADJUSTMENTS
GR-1	REPORT OF CORE BORINGS
GR-2	SOIL PROFILES
GR-3	ROADWAY SOILS SURVEY
CTL-1 - CTL-2	PROJECT SURVEY CONTROL
UTV-1 - UTV-2	SUMMARY OF VERIFIED UTILITIES

PALM BEACH COUNTY  
BROWARD COUNTY

END PROJECT  
END BRIDGE  
STA. 893+31.45  
MP 13.301

BEGIN PROJECT  
STA. 821+50.00  
MP 11.941

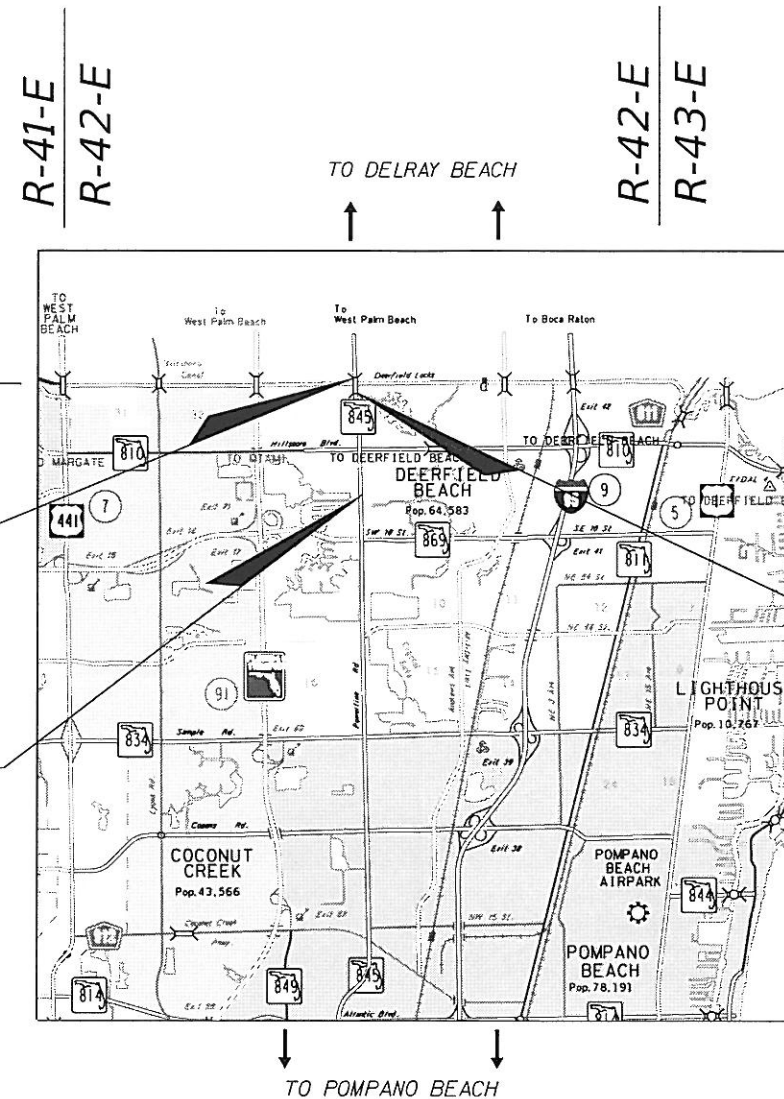

T-47-S  
T-48-S  
BEGIN BRIDGE  
STA. 891+81.45  
MP 13.272

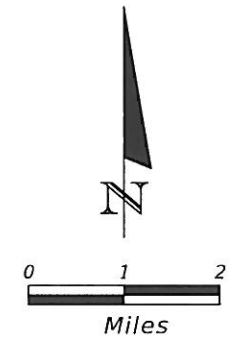

ROADWAY SHOP DRAWINGS  
TO BE SUBMITTED TO:  
MORAYMA OCHOA  
DISTRICT 4 STRUCTURES OFFICE  
3400 WEST COMMERCIAL BLVD.  
FORT LAUDERDALE, FL. 33309-3421

PLANS PREPARED BY:  
GARY S. WHEELER  
DISTRICT 4 IN-HOUSE DESIGN SECTION 2  
3400 WEST COMMERCIAL BLVD.  
FORT LAUDERDALE, FL. 33309-3421  
(954) 777-4416 OR (954) 777-2254

NOTE: THE SCALE OF THESE PLANS MAY  
HAVE CHANGED DUE TO REPRODUCTION.

PHASE SUBMITTAL: INITIAL

ROADWAY PLANS  
ENGINEER OF RECORD: SCOTT PETERSON

P.E. NO.: 52740

FISCAL YEAR	SHEET NO.
15	1

**GOVERNING STANDARDS AND SPECIFICATIONS:**  
Florida Department of Transportation, 2014 Design Standards and revised Index Drawings as appended herein, and 2014 Standard Specifications for Road and Bridge Construction, as amended by Contract Documents.

For Design Standards click on the "Design Standards" link at the following web site:  
<http://www.dot.state.fl.us/rddesign/>

For the Standard Specifications for Road and Bridge Construction click on the "Specifications" link at the following web site:  
<http://www.dot.state.fl.us/specificationsoffice/>

REVISIONS

LENGTH OF PROJECT		
	LINEAR FEET	MILES
ROADWAY	7032.00	1.332
BRIDGES	150.00	0.028
NET LENGTH OF PROJECT	7182.00	1.360
EXCEPTIONS	0.00	0.00
GROSS LENGTH OF PROJECT	7182.00	1.360

FDOT PROJECT MANAGER: SCOTT PETERSON P.E.

KEY SHEET REVISIONS	
DATE	DESCRIPTION

**STATE OF FLORIDA  
DEPARTMENT OF TRANSPORTATION**

**CONCEPTUAL PLANS**

FINANCIAL PROJECT ID 430605-1-52-01  
BROWARD COUNTY (86065000)  
STATE ROAD NO. 845

LOCATION OF PROJECT

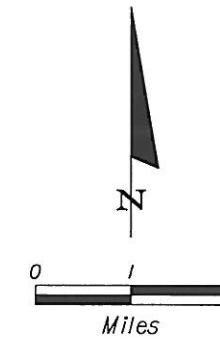
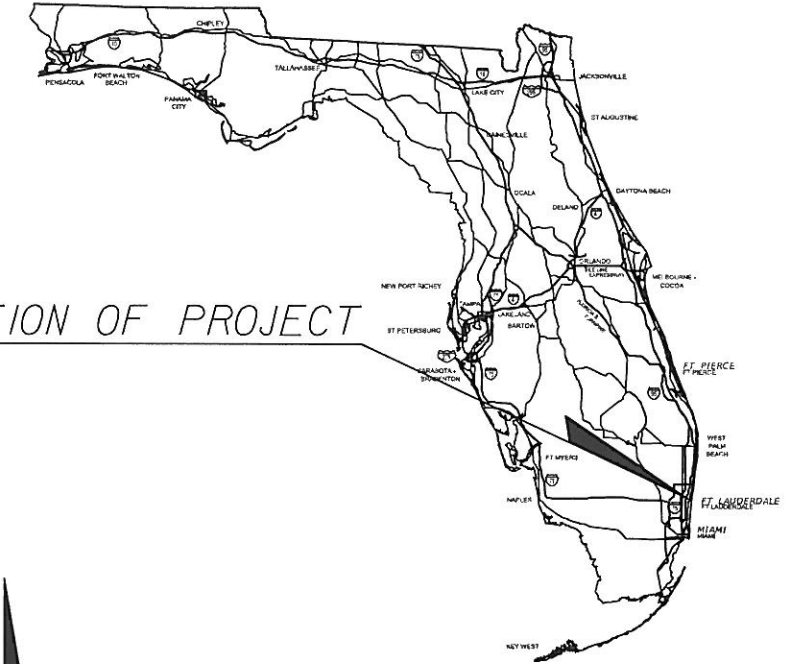

SIGNING AND PAVEMENT MARKING SHOP DRAWINGS  
TO BE SUBMITTED TO:  
MORAYMA OCHOA  
DISTRICT IV STRUCTURES OFFICE  
3400 WEST COMMERCIAL BLVD.  
FORT LAUDERDALE, FL 33309

PLANS PREPARED BY:  
BENJAMIN RESTREPO  
TRAFFIC DESIGN  
3400 WEST COMMERCIAL BLVD.  
FT. LAUDERDALE, FL 33309

NOTE: THE SCALE OF THESE PLANS MAY  
HAVE CHANGED DUE TO REPRODUCTION.

INDEX OF SIGNING AND PAVEMENT MARKING PLANS

SHEET NO.	SHEET DESCRIPTION
S-1	KEY SHEET
S-2 - S-3	TABULATION OF QUANTITIES
S-4 - S-16	SIGNING AND PAVEMENT MARKINGS
S-17 - S-18	GUIDE SIGN
S-19	TYPICAL RPM PLACEMENT AT TRAFFIC CONTROL ISLANDS

**SIGNING AND PAVEMENT MARKING PLANS**

REVISIONS

CONSTRUCTABILITY SUBMITTAL  
1/28/2014 2:29:32 PM  
SUBJECT TO REVISION

KEY SHEET REVISIONS		
DATE	BY	DESCRIPTION

ROADWAY PLANS  
ENGINEER OF RECORD: SCOTT PETERSON

P.E. NO.: 52740

FISCAL YEAR	SHEET NO.
15	S-1

FDOT PROJECT MANAGER: SCOTT PETERSON, P.E.

TABULATION OF QUANTITIES

PAY ITEM NO.	DESCRIPTION	UNIT	SHEET NUMBERS														TOTAL THIS SHEET		GRAND TOTAL		REF. SHEET		
			S-4		S-5		S-6		S-7		S-8		S-9		S-10		S-11		PLAN	FINAL		PLAN	FINAL
			PLAN	FINAL	PLAN	FINAL	PLAN	FINAL	PLAN	FINAL	PLAN	FINAL	PLAN	FINAL	PLAN	FINAL							
0700-1-11	Single Post, up to 12 SF	AS	3.0		2.0		2.0		1.0				1.0		0.0		1.0		10.0		22.0		
0700-1-12	Single Post, 12-20 SF	AS	0.0				1.0				2.0		1.0		1.0				5.0		6.0		
0700-1-50	Single Post Sign Relocate	AS	0.0				2.0		3.0		3.0		3.0		2.0				13.0		14.0		
0700-1-60	Single Post Sign Remove	AS	1.0		1.0										2.0				4.0		6.0		
0700-2-60	Multi Post Sign Remove	AS																			2.0		
0700-2-12	Multi Post Sign F&I, Ground Mount 12-20 SF	AS	0.0														1.0		1.0		1.0		
0700-2-13	Multi Post Sign F&I, Ground Mount 21-30 SF	AS			1.0							1.0							2.0		2.0		
0700-2-14	Multi Post Sign F&I, Ground Mount 31-50 SF	AS																	1.0		3.0		
0700-2-15	Multi Post Sign F&I, Ground Mount 51-100 SF	AS			1.0			1.0											2.0		2.0		
0700-3-101	Sign Panel F&I, Ground Mount, Up to 12 SF	AS			1.0					1.0									2.0		2.0		
0705-10-1	Object Marker, Type 1	EA																	0.0		3.0		
0705-11-3	Delineator, Flexible High Visibility Median	EA				1.0								2.0					3.0		3.0		
0710-90	Painted Pavement Markings, Final Surface	LS																	1.0		1.0		
																			0.0		0.0		
*	Reflective Pavement Markers (Y/Y)	EA	102.0				44.0		36.0		37.0		47.0		111.0		91.0		582.0		867.0		
*	Reflective Pavement Markers (W/R)	EA	62.0		48.0		143.0		83.0		101.0		125.0		146.0		154.0		1006.0		1315.0		
*	Painted Pavement Markings, White, Solid, 6"	NM	0.2		0.3		0.5		0.4		0.3		0.4		0.7		0.4		3.8		5.2		
*	Painted Pavement Markings, White, Solid, 8"	LF	191.0		88.0		884.0		442.0		429.0		635.0		625.0		1092.0		5108.0		6017.0		
*	Painted Pavement Markings, White, Solid, 12"	LF	379.0		123.0		813.0		79.0		374.0		303.0		1140.0		440.0		3889.0		5039.0		
*	Painted Pavement Markings, White, Solid, 18"	LF					106.0				66.0		0.0						172.0		172.0		
*	Painted Pavement Markings, White, Solid, 24"	LF	122.0				139.0		18.0		58.0		113.0		1160.0		126.0		1797.0		2741.0		
*	Painted Pavement Markings, White, Skip, 6" (10/30)	GM	0.0		0.2		1.1		0.3		0.4		0.4		0.2		0.3		3.4		4.3		
*	Painted Pavement Markings, White, Skip, 6" (2/4)	LF	74.0		50.0		288.0		283.0		468.0		518.0		373.0		342.0		2749.0		3430.0		
*	Painted Pavement Markings, White, Skip, 6" (6/10)	LF			108.0		6.0		74.0		88.0		162.0		18.0		78.0		786.0		1198.0		
*	Painted Pavement Markings, Message (ONLY)	EA	3.0		1.0		5.0		3.0		4.0		6.0		1.0		3.0		28.0		30.0		
*	Painted Pavement Markings, Message (SCHOOL)	EA											3.0				3.0		8.0		12.0		
*	Painted Pavement Markings, Pavement Message (BUS)	EA	1.0				1.0				1.0								3.0		3.0		
*	Painted Pavement Markings, Arrows (Right Dir. Arrow)	EA	1.0		0.0		3.0		6.0		8.0		11.0		9.0		13.0		58.0		76.0		
*	Painted Pavement Markings, Arrows (Left Dir. Arrow)	EA	2.0		4.0		7.0		2.0		2.0		7.0		12.0		6.0		49.0		66.0		
*	Painted Pavement Markings, Arrows (Bike Thru Arrow)	EA	3.0		2.0		4.0		2.0		3.0		2.0		7.0		4.0		31.0		43.0		
*	Painted Pavement Markings, Arws (LT.Turn-Thru.Dir.Arws)	EA	1.0										0.0						1.0		1.0		
*	Painted Pavement Markings, Arrows (Dual Turn Dir.Arws)	EA	0.0										0.0				1.0		1.0		1.0		
*	Painted Pavement Markings, Arrows (Thru Dir. Arrow)	EA	0.0										0.0						0.0		1.0		
*	Painted Pavement Markings, Yellow, Solid, 6"	NM	0.1		0.2		0.2		0.3		0.2		0.2		0.3		0.3		2.3		3.3		
*	Painted Pavement Markings, Yellow, Solid, 18"	LF							12.0						25.0		25.0		174.0		286.0		
*	Painted Pavement Markings, Yellow, Skip, 6" (6/10)	LF							6.0		12.0		12.0		30.0		30.0		77.0		166.0		
*	Painted Pavement Markings, Yellow, Island Nose	SF	39.8				59.5		31.0		28.7		36.9		6.1		1549.9		1837.1		1954.1		
0711-14-160	Thermo Pavement Markings, Message (Bike Symbol)	EA	2.0		2.0		4.0		2.0		3.0		2.0		7.0		4.0		26.0		38.0		
																			0.00		0.00		
																			0.00		0.00		
																			0.00		0.00		
																			0.00		0.00		
																			0.00		0.00		
																			0.00		0.00		
																			0.00		0.00		
																			0.00		0.00		
																			0.00		0.00		
																			0.00		0.00		
																			0.00		0.00		
																			0.00		0.00		
																			0.00		0.00		
																			0.00		0.00		

\* THESE QUANTITIES ARE PAID FOR UNDER PAINTED PAVEMENT MARKINGS (FINAL SURFACE), LUMP SUM - ITEM NO. 710-90. THE QUANTITIES SHOWN ARE FOR ONE APPLICATION; SEE SPECIFICATION 710 FOR THE NUMBER OF APPLICATIONS REQUIRED.

REVISIONS				ENGINEER OF RECORD		STATE OF FLORIDA			SHEET NO.
DATE	DESCRIPTION	DATE	DESCRIPTION	SCOTT PETERSON, P.E.		DEPARTMENT OF TRANSPORTATION			
				P.E. NO. 52740		ROAD NO.	COUNTY	FINANCIAL PROJECT ID	
				3400 WEST COMMERCIAL BLVD		845	BROWARD	430605-1-52-01	TABULATION OF QUANTITIES
				FORT LAUDERDALE, FL 33309					S-2
				954-777-4416					

TABULATION OF QUANTITIES

PAY ITEM NO.	DESCRIPTION	UNIT	SHEET NUMBERS																TOTAL THIS SHEET		GRAND TOTAL		REF. SHEET
			S-12		S-13		S-14		S-15		S-16												
			PLAN	FINAL	PLAN	FINAL	PLAN	FINAL	PLAN	FINAL	PLAN	FINAL	PLAN	FINAL	PLAN	FINAL	PLAN	FINAL	PLAN	FINAL			
0700-1-11	Single Post, up to 12 SF	AS	2.0		1.0		2.0		7.0										12.0				
0700-1-12	Single Post, 12-20 SF	AS						1.0											1.0				
0700-1-50	Single Post Sign Relocate	AS						1.0											1.0				
0700-1-60	Single Post Sign Remove	AS						1.0		1.0									2.0				
0700-2-60	Multi Post Sign Remove	AS	2.0																2.0				
0700-2-12	Multi Post Sign F&I, Ground Mount 12-20 SF	AS																	0.0				
0700-2-13	Multi Post Sign F&I, Ground Mount 21-30 SF	AS																	0.0				
0700-2-14	Multi Post Sign F&I, Ground Mount 31-50 SF	AS			1.0				1.0										2.0				
0700-2-15	Multi Post Sign F&I, Ground Mount 51-100 SF	AS																	0.0				
0700-3-101	Sign Panel F&I, Ground Mount, Up to 12 SF	AS																	0.0				
0705-10-1	Object Marker, Type 1	EA							3.0										3.0				
0705-11-3	Delineator, Flexible High Visibility Median	EA																	0.0				
0710-90	Painted Pavement Markings, Final Surface	LS																	0.0				
*	Reflective Pavement Markers (Y/Y)	EA	29.0		85.0		127.0		44.0		0.0								285.0				
*	Reflective Pavement Markers (W/R)	EA	73.0		71.0		89.0		60.0		16.0								309.0				
*	Painted Pavement Markings, White, Solid, 6"	NM	0.3		0.3		0.5		0.3		0.1								1.5				
*	Painted Pavement Markings, White, Solid, 8"	LF	380.0		342.0		187.0												909.0				
*	Painted Pavement Markings, White, Solid, 12"	LF	98.0		140.0		717.0		128.0		67.0								1150.0				
*	Painted Pavement Markings, White, Solid, 18"	LF																	0.0				
*	Painted Pavement Markings, White, Solid, 24"	LF			61.0		811.0		72.0										944.0				
*	Painted Pavement Markings, White, Skip, 6" (10/30)	GM	0.2		0.2		0.1		0.2		0.1								0.9				
*	Painted Pavement Markings, White, Skip, 6" (2/4)	LF	131.0		222.0		56.0		168.0		104.0								681.0				
*	Painted Pavement Markings, White, Skip, 6" (6/10)	LF	150.0		102.0		41.0		119.0										412.0				
*	Painted Pavement Markings, Message (ONLY)	EA	1.0		1.0														2.0				
*	Painted Pavement Markings, Message (SCHOOL)	EA			2.0				2.0										4.0				
*	Painted Pavement Markings, Pavement Message (BUS)	EA																	0.0				
*	Painted Pavement Markings, Arrows (Right Dir. Arrow)	EA	3.0		4.0		8.0		3.0										18.0				
*	Painted Pavement Markings, Arrows (Left Dir. Arrow)	EA	4.0		3.0		8.0		2.0										17.0				
*	Painted Pavement Markings, Arrows (Bike Thru Arrow)	EA	2.0		2.0		3.0		2.0		3.0								12.0				
*	Painted Pavement Markings, Arws (LT.Turn-Thru.Dir.Arws)	EA																	0.0				
*	Painted Pavement Markings, Arrows (Dual Turn Dir. Arw)	EA																	0.0				
*	Painted Pavement Markings, Arrows (Thru Dir. Arrow)	EA					1.0												1.0				
*	Painted Pavement Markings, Yellow, Solid, 6"	NM	0.2		0.2		0.2		0.2		0.1								1.0				
*	Painted Pavement Markings, Yellow, Solid, 18"	LF	4.0		108.0														112.0				
*	Painted Pavement Markings, Yellow, Skip, 6" (6/10)	LF			17.0				72.0										89.0				
*	Painted Pavement Markings, Yellow, Island Nose	SF	28.4		56.8		14.9		16.9										117.0				
0711-11-123	Thermoplastic, STD White, Solid, 12"	LF									250								250.00				
0711-11-170	Thermoplastic, STD White, Arrow	EA									2.00								0.00				
0711-14-160	Thermoplastic, Preformed, White, Message (Bike Symbol)	EA	2.0		2.0		3.0		2.0		3.0								12.0				
0711-16-111	Thermoplastic, STD-OTH, White, Solid, 6"	NM									0.17								0.17				
0711-16-211	Thermoplastic, STD-OTH, Yellow, Solid, 6"	NM									0.06								0.06				
																			0.00				
																			0.00				
																			0.00				
																			0.00				
																			0.00				
																			0.00				
																			0.00				
																			0.00				
																			0.00				
																			0.00				
																			0.00				
																			0.00				
																			0.00				
																			0.00				
																			0.00				
																			0.00				
																			0.00				

\* THESE QUANTITIES ARE PAID FOR UNDER PAINTED PAVEMENT MARKINGS (FINAL SURFACE), LUMP SUM - ITEM NO. 710-90. THE QUANTITIES SHOWN ARE FOR ONE APPLICATION; SEE SPECIFICATION 710 FOR THE NUMBER OF APPLICATIONS REQUIRED.

DATE		DESCRIPTION		DATE		DESCRIPTION		ENGINEER OF RECORD <b>SCOTT PETERSON, P.E.</b> P.E. NO. 52740 3400 WEST COMMERCIAL BLVD FORT LAUDERDALE, FL 33309 954-777-4416			STATE OF FLORIDA DEPARTMENT OF TRANSPORTATION ROAD NO. COUNTY FINANCIAL PROJECT ID 845 BROWARD 430605-1-52-1			<b>TABULATION OF QUANTITIES</b>				SHEET NO. S-3
------	--	-------------	--	------	--	-------------	--	---	--	--	---	--	--	---------------------------------	--	--	--	------------------

BEGIN PAVEMENT MARKINGS

☉ STA. 822+58.00

BEGIN SIGNING

☉ STA. 821+92.30

R/W LINE

☉ CONST.

R/W LINE

0700-1-11

0700-1-11

EXISTING TO REMAIN

EXISTING TO REMAIN

EXISTING TO REMAIN

R5-1  
36"X36"

R5-1  
36"X36"



THANK YOU  
FOR VISITING  
QUIET WATERS  
PARK



R6-1L  
36"X12"

R6-1L  
36"X12"

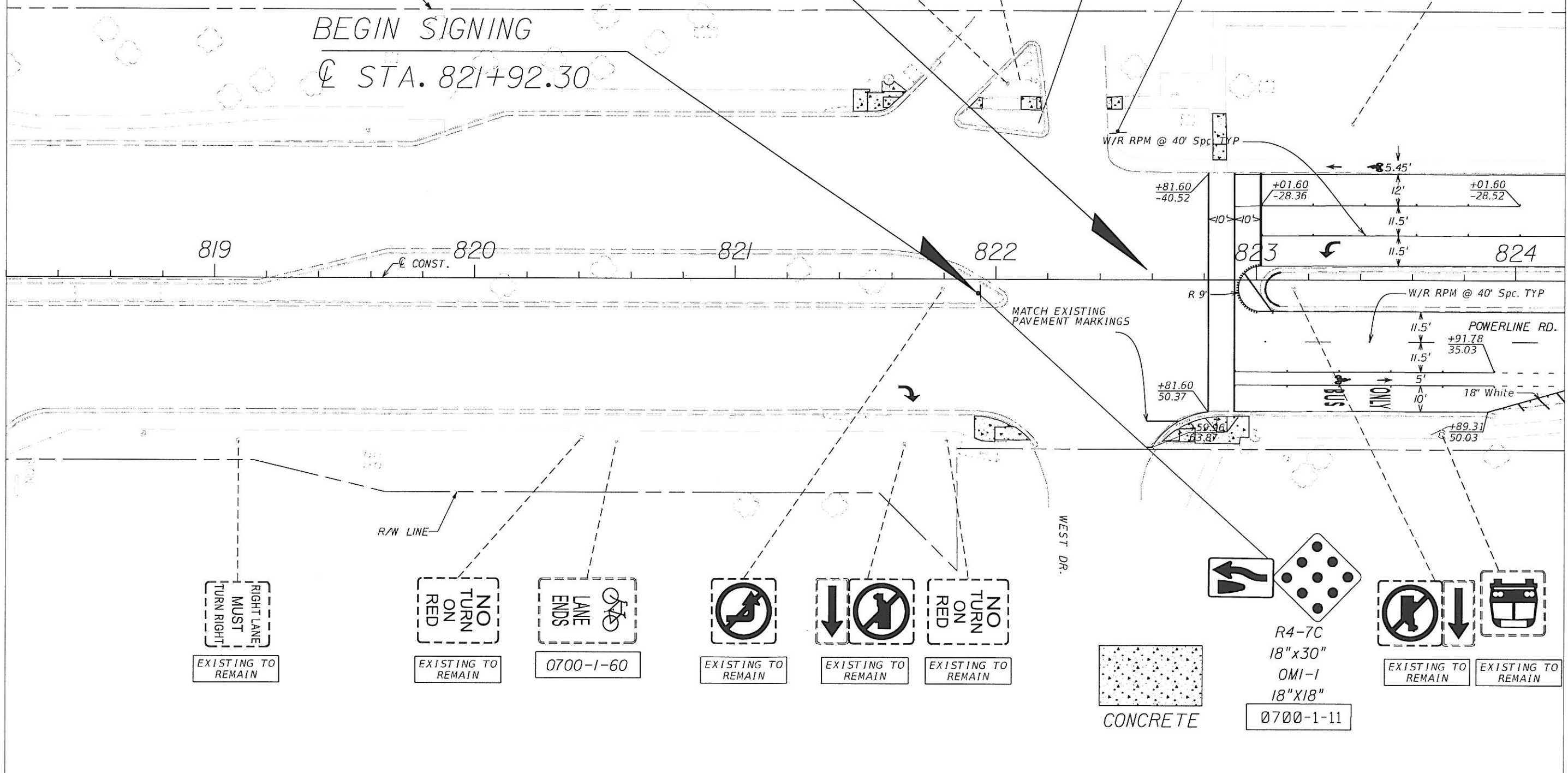
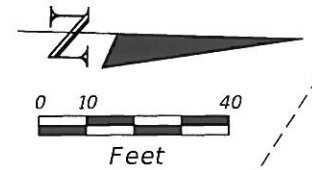

RIGHT LANE  
MUST  
TURN RIGHT

EXISTING TO REMAIN

NO  
TURN  
ON  
RED

EXISTING TO REMAIN

LANE  
ENDS

0700-1-60



EXISTING TO REMAIN



EXISTING TO REMAIN

NO  
TURN  
ON  
RED

EXISTING TO REMAIN

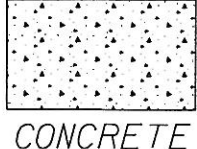

CONCRETE



R4-7C  
18"x30"

0700-1-11



EXISTING TO REMAIN



EXISTING TO REMAIN

REVISIONS			
DATE	DESCRIPTION	DATE	DESCRIPTION

ENGINEER OF RECORD  
**SCOTT PETERSON, P.E.**  
 P.E. NO. 52740  
 3400 WEST COMMERCIAL BLVD  
 FORT LAUDERDALE, FL 33309  
 954-777-4416

STATE OF FLORIDA DEPARTMENT OF TRANSPORTATION		
ROAD NO.	COUNTY	FINANCIAL PROJECT ID
845	BROWARD	430605-1-52-01

**SIGNING AND PAVEMENT  
MARKINGS**

SHEET NO.  
S-4

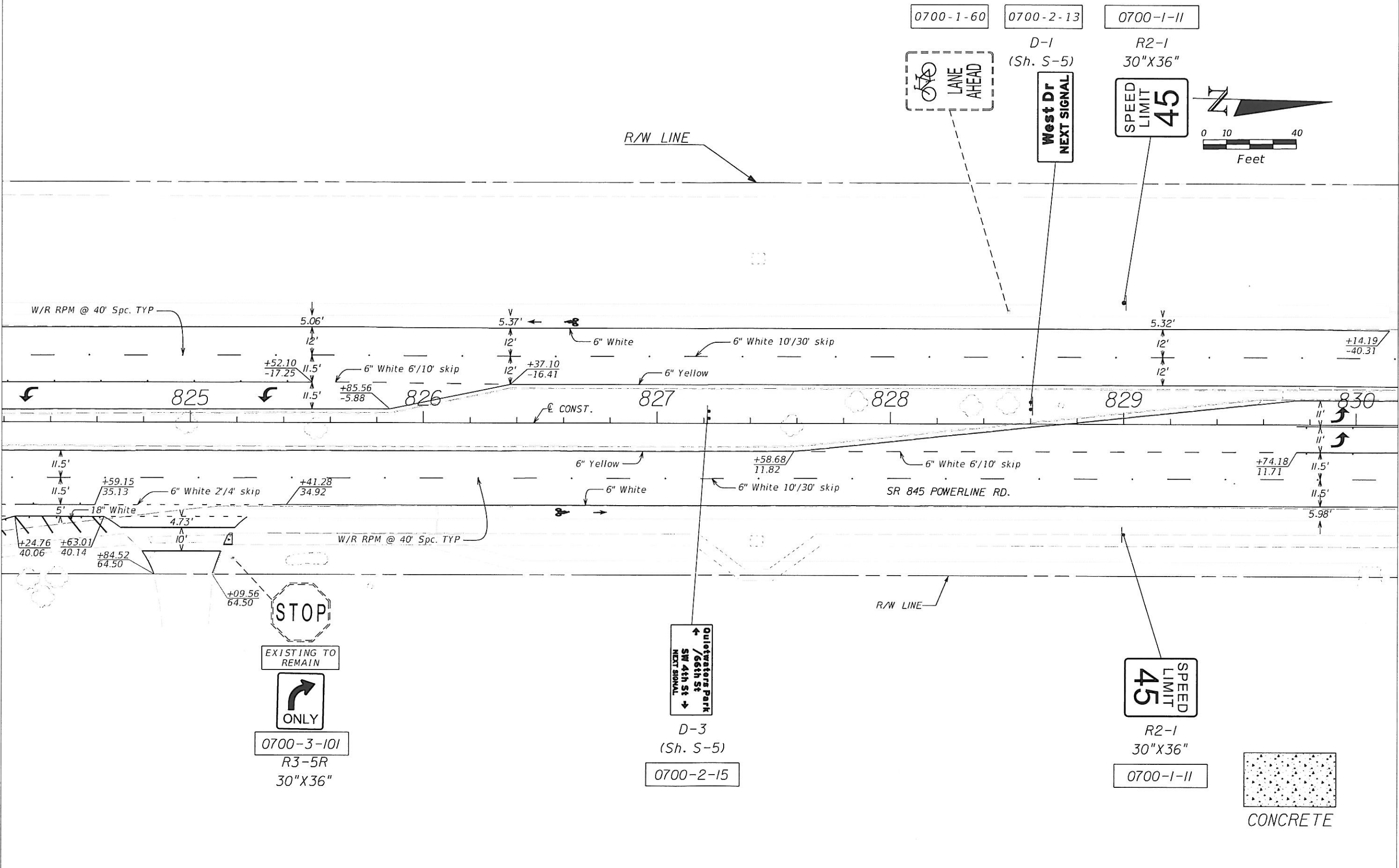

REVISIONS				ENGINEER OF RECORD SCOTT PETERSON, P.E. P.E. NO. 52740 3400 WEST COMMERCIAL BLVD FORT LAUDERDALE, FL 33309 954-777-4416	STATE OF FLORIDA DEPARTMENT OF TRANSPORTATION			SHEET NO. S-5
DATE	DESCRIPTION	DATE	DESCRIPTION		ROAD NO.	COUNTY	FINANCIAL PROJECT ID	
					845	BROWARD	430605-1-52-01	

**SIGNING AND PAVEMENT MARKINGS**

0700-1-50



EXISTING TO REMAIN



EXISTING TO REMAIN



0700-1-11

W11-2  
30"X30"  
W16-7PR  
24"X12"

0700-1-50

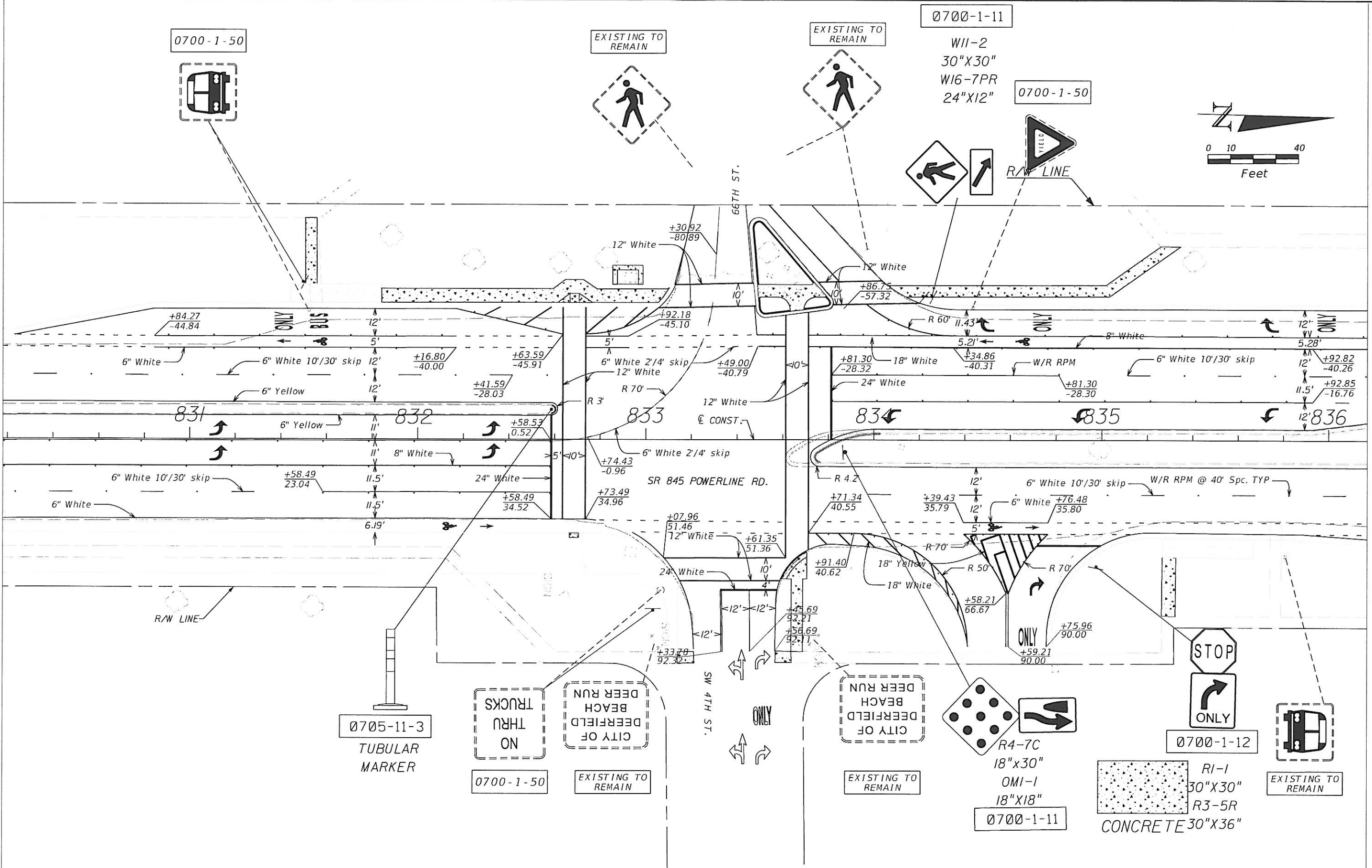
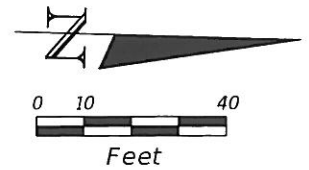

0705-11-3  
TUBULAR  
MARKER

TRUCKS  
THRU  
ON

0700-1-50

DEERFIELD  
BEACH  
CITY OF

EXISTING TO  
REMAIN

DEERFIELD  
BEACH  
CITY OF

EXISTING TO  
REMAIN

R4-7C  
18"X30"  
OMI-1  
18"X18"

0700-1-11

CONCRETE  
30"X36"



0700-1-12



EXISTING TO  
REMAIN

REVISIONS			
DATE	DESCRIPTION	DATE	DESCRIPTION

ENGINEER OF RECORD  
**SCOTT PETERSON, P.E.**  
 P.E. NO. 52740  
 3400 WEST COMMERCIAL BLVD  
 FORT LAUDERDALE, FL 33309  
 954-777-4416

STATE OF FLORIDA DEPARTMENT OF TRANSPORTATION		
ROAD NO.	COUNTY	FINANCIAL PROJECT ID
845	BROWARD	430605-1-52-01

**SIGNING AND PAVEMENT  
MARKINGS**

SHEET  
NO.  
S-6

SUSERS

SDATES

STIMES

SFILES